

# Northwest Managers of Educational Technology 2025 Conference Program



***Bridging Technology and Pedagogy***



## Welcome to the NW/MET Conference 2025

Dear NW/MET Family,

Just over two years ago, I started working at Boise State University as an Instructional Technologist. My director, Leif Nelson, suggested I get involved with NW/MET for professional development. It sounded perfect, and he asked that I give a warm hello to the friends of NW/MET. I thought, "Sure, why not!" and headed to Helena, Montana. I quickly found myself among a group of people that had only the highest regard for Leif and had missed his and BSU's presence greatly. The rest is history, and after 9 years NW/MET has returned to Boise State University.

As the NW/MET 2025 Conference Director, I want to welcome everyone back to Boise! You'll find our campus has changed as much as the city of Boise itself. Our campus has grown into a hub for cutting-edge learning and collaboration, featuring newly constructed research labs, modern dormitories, and vibrant study areas for students of all programs. The Micron Center for Materials Research and the Center for the Visual Arts highlight our dedication to nurturing imagination, exploration, and student success. We invite you to explore a campus designed from the ground up to foster ingenuity and mold tomorrow's leaders. Our Athletics program has broken numerous records and claimed regional titles. Our Broncos have displayed tenacity, talent, and a relentless drive for excellence. Boise State University remains a leader in pedagogical innovation, research distinction, athletic dominance, and transformative education. It is a perfect place for NW/MET to convene this year, where we will present and attend sessions engaged with how to continue striving for excellent AV and pedagogical technology use.

I want to recognize the incredible work of Erika Krishnek and Nicole Carrobis-Malone for helping to make NW/MET 2025 happen. I'd also like to recognize and express gratitude for Boise State's Office of Information Technology leadership Leif Nelson and Peter Jurhs. Both Leif and Peter have shown incredible guidance and support for Erika and I over the last two years while we planned the next several of your days here.

Finally, I'd like to extend a personal and heartfelt thank you to each and every one of you for joining us at this year's conference, and for helping to make it one of our biggest conferences yet. It's the people who make this event special, and I'm excited to keep learning and growing with you in the years ahead.

Best,

*Zane McCarty*

Zane McCarty  
Conference Director





## NW/MET

The Northwest Managers of Educational Technology (NW/MET) is a consortium of Educational Technology professionals from colleges and universities in the American Pacific Northwest and Intermountain regions and Western Canada. With membership that has expertise in software, hardware, A/V, and instructional design, NW/MET is an easy way to stay ahead of the curve while staying close to home. NW/MET began officially in 1978, making it one of the oldest support groups for A/V professionals in the world.

NW/MET is an organization bridging tradition and innovation for academics. We offer our members an opportunity to present results of research and experiences and network with professionals in a region



whose problems and solutions are similar. Our objectives are to develop an identity among professionals managing media services, faculty and instructional development, media production, and other educational technology services in higher education institutions in the Northwest, and to improve the process of managing faculty and instructional support programs.

## NW/MET Leadership

The President, Vice-President, Treasurer, and Secretary of the Northwest Managers of Educational Technology are elected to four-year terms and are tasked with the day-to-day operations of the organization. The Conference Director is an annual position awarded to the host institution of the upcoming conference.

President:	Raul Burriel, Oregon State University
Vice-President:	Dan Case, Carroll College
Treasurer:	Andrew Borts, University of Nevada Las Vegas
Secretary:	Brian Myers, Portland State University
Conference Director:	Zane McCarty, Boise State University

## The Talking Stick



Drawing from our Northwest tradition, every year NW/MET bestows upon our conference host the Talking Stick. For thousands of years West Coast Natives used Talking Sticks during Potlatches and other ceremonial occasions as a symbol of speaking authority and respect for communication by Chiefs, Elders, and all other witnesses. These sticks were carved from yellow cedar with various animal and mystical family crests signifying human attributes. The Talking Stick affords the holder the honor and responsibility to speak uninterrupted. It also serves as a reminder to the witnesses of their vital role of listening thoughtfully. Once the stick has been passed, the honor of speech has been transferred. The NW/MET Talking Stick was hand carved by Coast Salish artist Jim Yelton and represents the Bear. The Bear is the Spirit symbol of strength, agility, and guidance.

## MET Money

At each NW/MET conference, attendees receive a special currency known as **MET Money**—a dazzling, one-of-a-kind play money designed to spice up the event and add a little extra excitement to the events. Forget cash—this colorful, MET currency is your golden ticket to the auction on Thursday night, where you can bid on a range of fun and fabulous prizes, from quirky gadgets to exclusive items. Make friends with our sponsors and exhibitors to earn MET Money - because on the final night, your MET Money could make you the proud owner of something truly unique. The more MET Money you have, the better your chances to score big!



## NW/MET Hall of Fame Inductions 2025

NW/MET likes to celebrate our membership -- our family -- by inducting members into the Hall of Fame and shine a light on successes and influences that our members bring to the organization. Inductees will receive an emeritus membership and recognition at the Annual Conference. In 2025, we induct Blake Beck, Randy Stamm, and Lou Hong into the Hall of Fame.

### Blake Beck



Blake Beck was born in a small town of 600 people in Utah. He eventually went to Utah State University where he graduated in 1989 with a Business Degree in Finance and went to work at the Idaho National Laboratory in Project Management and Project Control. He completed his MBA from Idaho State University in 1994. He went to work for WorkForce Training in the state of Idaho in 1998, working to connect classrooms around the state of Idaho via Distance Learning Technology at the time. In 2001 he accepted a job teaching in the Marketing and Management program at Idaho State University using technology to connect classes and online software to move courses to the Web. He completed a Masters of Education in Instructional Technology in 2002. In 2004 he was hired as the Director of Educational Technology at Idaho State University where he was employed for the next 20+ years helping ISU expand their online offerings to over 2,500 courses and deploying technology in the classrooms to connect rooms in Pocatello, Idaho Falls, Twin Falls, and Meridian Idaho in order to facilitate ISU reaching students in various disciplines that would not have been able to take advantage of a higher education otherwise. During his 25+ years of employment in Higher Education he has met many fabulous people that have shared his vision for extending higher education and its opportunities to those that had not been able to access it in the past. Many of the best people he has met have been involved in Educational Technology, specifically the Northwest Managers of Educational Technology, and played host to the NW/MET conference here in Boise, in 2010. This organization has provided lifelong friendships, friends with shared values and goals, and a place to learn and develop ideas on how to accomplish the work of extending higher education opportunities better.

Currently, Blake is a full-time faculty member in the Business Management Program at The College of Eastern Idaho. He has spent his professional career trying to live by the core value that education is the great equalizer and the belief that brains and ability are distributed evenly in the world, what is not distributed evenly is opportunity.

Blake is married to the beautiful Angie Beck, and they have been married for 37 years. They are the parents of 4 beautiful children and are now grandparents to three beautiful little people that occupy much of their time and thoughts. Blake continues to reside in Pocatello Idaho and is grateful to Higher Education for providing him opportunities as a first-generation college graduate and engaging and challenging employment for the past 40+ years.

## Randy Stamm



Randy Stamm, a newly retired educational technologist and instructional design director from Idaho State University, brings over 30 years of experience in higher education. His career began in print graphic design, evolving alongside the digital revolution into website development, web conferencing, and ultimately the evaluation and implementation of learning management systems. Throughout his journey, he has been dedicated to advancing eLearning initiatives, promoting open educational resources, and collaborating with faculty and students to create transformative learning experiences. His work has been defined by a commitment to innovation, leveraging emerging technologies to foster inclusive, engaging, and learner-centered environments.

Randy has been a long-time participant and contributor to the Northwest Managers of Educational Technology.

More recently, Dr. Stamm has focused on sharing his expertise in artificial intelligence to enhance efficiency and creativity within educational settings, continuing to inspire and support the next generation of instructional technologists.

## Lou Hong



Lou Hong is a seasoned Senior Hardware and Software Technologist at Idaho State University (ISU), serving within the Information Technology Services (ITS) department. With over 25 years of experience in IT support across corporate, government, and academic environments, Lou plays a critical role in maintaining, troubleshooting, and optimizing technology infrastructure for students, faculty, and staff.

Lou specializes in diagnosing and resolving complex technical issues, ensuring seamless hardware operations, and managing IT assets efficiently. His expertise spans system imaging, network configurations, cybersecurity best practices, and the integration of emerging technologies into classroom environments. Dedicated to continuous improvement, he evaluates new technological trends to enhance the university's IT landscape.

Beyond technical proficiency, Lou is committed to exceptional customer service, delivering user-friendly support that enhances both educational and administrative functions at ISU. His ability to bridge technology and people ensures a smooth and productive experience for all users.

Lou Hong has been a fixture at NW/MET for years, as a conference attendee, a member of the executive committee, and as the de facto photographer. If you're wondering why it is that Lou's rarely in any pictures from the NW/MET conferences, it's because he's behind the camera. It's no exaggeration to say that if not for Lou, much of the history and happenings of NW/MET over the past many years would have been lost.

Outside of work, Lou enjoys spending quality time with his family and capturing moments behind the camera, blending his passion for technology with a love for photography.



**Boise State University**





Boise State University (BSU) is a public research university located in Boise, Idaho. Established in 1932, it has grown into a prominent institution known for its dynamic academic programs, diverse student body, and strong commitment to community engagement. The university offers a wide range of undergraduate and graduate programs across various disciplines. BSU is particularly renowned for its innovative research in areas like environmental science and technology, as well as its vibrant athletic culture, with the iconic "Blue Turf" of the football field serving as a symbol of school spirit. Nestled in the foothills of the Rocky Mountains, Boise State also provides students with unparalleled outdoor recreational opportunities, making it an attractive destination for both academics and adventure.



## BOISE STATE UNIVERSITY

### Land Acknowledgement

Boise State University was established upon the ancestral homelands of the Original Boise Valley People – the Newe (Shoshone), Numu (Paiute), and the Panakwate (Bannock) People – whose descendants are citizens of the Shoshone-Bannock Tribes of Fort Hall, the Shoshone-Paiute Tribes of Duck Valley, Fort McDermitt Paiute-Shoshone Tribe, the Burns Paiute Tribe, and the Confederated Tribes of Warm Springs. As an institution of higher learning, we recognize the historical impact federal policies have had on tribal people. We acknowledge the importance of strengthening tribal community engagement and offering rich historical and cultural education at Boise State University.



## Boise State Parking Information

**P** Parking is included for all NW/MET 2025 Conference attendees. The Lincoln Parking Garage is across the street from our venue in the Student Union Building on the corner of Lincoln Avenue and University Drive. A special page/tab for NW/MET will be found on the parkin terminal of the Lincoln Garage and the Stadium Commuter lot. Select the tab and enter your license plate number to obtain your free parking pass.

## Conference and Event Locations

The 2025 NW/MET Conference is hosted at Boise State University, with events happening both on and off campus. Find locations and addresses below.

### Tuesday Social Gathering

**Welcome Reception at Beside Bardenay -- Presented by Crestron**

**Address: 610 W Grove St**

**Time: 5:30pm to 7:00pm**

Join us at Beside Bardenay for the pre-conference social hour hosted by Crestron. Enjoy drinks, food, and great company as we prepare for NW/MET 2025 Conference. Bardenay Restaurant & Distillery is located in Boise's iconic Basque Block. Beside Bardenay is the event space next door to the Distillery and Restaurant.



### All Conference Sessions

**BSU Student Union Building – 2<sup>nd</sup> floor**

**Address: 1700 W University Dr**

**Time: Wednesday 8:00am to 4:30pm**

**Thursday 8:00am to 4:30pm**

**Friday 8:00am to 9:30am**

The main conference sessions, along with breakfasts and lunches, will be held on the 2nd floor of the Student Union Building (SUB), located at the heart of the Boise State campus. All meals take place in the **Jordan Ballroom**. Lunch on Wednesday is presented by CDW. Lunch on Thursday is presented by Panopto. The Jordan Ballroom also serves as the exhibitor showcase each day where you can meet the NW/MET sponsors and collect your MET Money.



**BOISE STATE  
UNIVERSITY**

### Wednesday Dinner and Gathering

**Jordan Ballroom – Presented by Planar**

**Address: 1700 W University Dr**

**Time: Wednesday 6:00pm to 7:30pm**

The Jordan Ballroom on the 2<sup>nd</sup> Floor of the BSU Student Union Building is the location for our Wednesday evening gathering hosted by Planar. The Jordan Ballroom stands as Boise State's largest and most captivating ballroom, providing an exquisite backdrop for our NW/MET events. This versatile space will host all the breakfasts and lunches during the conference as well as our exhibitor showcase.



## Thursday Closing Party

Dinner and Closing Party in the Double R Ranch Room Stueckle Sky Center - Presented by Biamp

Address: 1200 W University Dr

Time: Photo on Blue Turf at 5:30pm

Event from 6:00pm to 9:30pm

The evening will start with a group photo on the Blue Turf. The Boise State University "Blue Turf" is one of the most iconic features of the university's Albertsons Stadium. Installed in 1986, it was the first of its kind in college football and has since become a symbol of Boise State's unique identity and success on the field. Following the photo, dinner and events will take place in the Stueckle Sky Center. Offering stunning panoramic views of the surrounding Boise foothills and the downtown skyline, the Double R Ranch Room is the location for dinner and annual NW/MET auction where participants can spend their MET Money.



**biamp.**

## Friday Innovative A/V Tour

After breakfast and NW/MET business meeting, join the group as we tour locations that highlight the mission of NW/MET. Transportation is available and will be announced at the conference.

### Boise State Stein Luminary

Address: 1110 S. Capitol Blvd. (Atrium of the Center for the Visual Arts)

Time: 10:00am to 11:15am



The Keith and Catherine Stein Luminary is an all-digital museum space, producing a range of immersive, interactive and sensory experiences. Combining touch-activated screens and immersive projection, the Luminary delivers cutting-edge content focused on visual and performing arts and cultural exhibitions for the Boise State community.

### Boise State eSports Arena

Address: 301 S Capitol Blvd

Time: 11:30am to 12:30pm



The Boise State Esports Arena is not only a hub for competition but also a vibrant host of local events that showcase the diversity and talent of the gaming community. The arena plays host to a myriad of exciting gatherings that bring gamers and enthusiasts together.

### Idaho State University - Meridian

Address: 1311 E Central Dr, Meridian, ID

Time: 1:00pm to 2:30pm



The anatomy labs at Idaho State University's Meridian campus are state-of-the-art facilities designed to provide students with hands-on learning experiences in the fields of health sciences and medical education. The labs are equipped with advanced tools and resources utilizing a combination of traditional methods and modern technologies to prepare students for careers in healthcare.



## Location Map – BSU Campus and Surrounding Area

Boise, Idaho, is in the southwestern part of the state, nestled along the Boise River and surrounded by foothills and rugged terrain. It serves as the state capital and is the largest city in Idaho, offering a mix of urban amenities and outdoor recreational opportunities. Boise State University is situated on the eastern edge of downtown Boise, near the river, and its campus is easily accessible from the city's central areas.

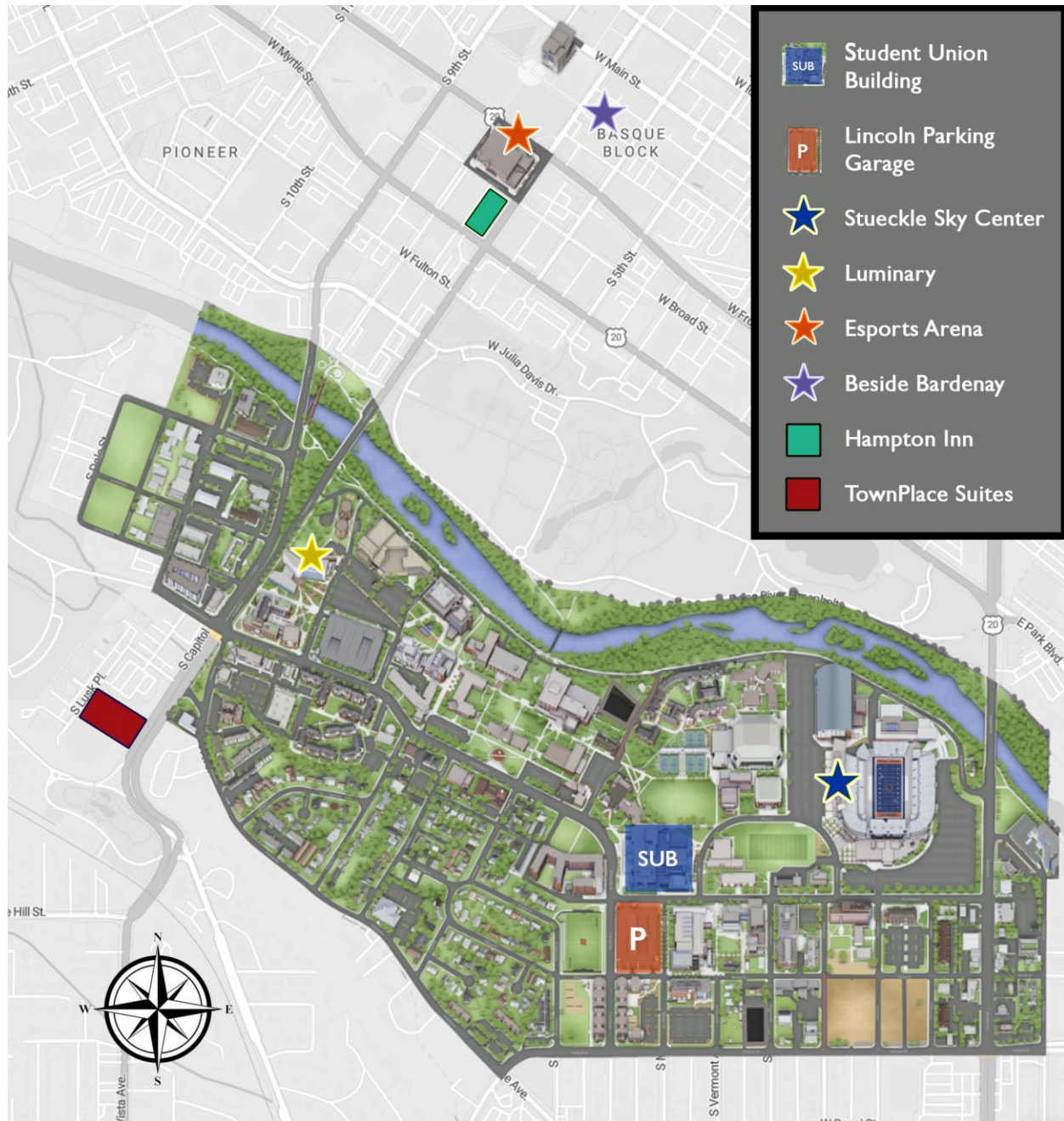

## Wednesday Conference Schedule

ROOM:	Bishop Barnwell	Farnsworth	Bergquist	
8:00am - 9:00am	<b>Breakfast</b> Student Union Building Jordan Ballroom			Meet the Sponsors of NW/MET in the Exhibitor Area
9:00am to 9:45am	Be Heard and Sound Better - How to setup audio DSP like an audio engineer <i>Jeremy Krug, Biamp</i>	Mastering USB-C and USB <i>Donald Trinh and Jason Parson, Atlona</i>	⚡ AI and Physical Spaces - Stop writing notes and start engaging <i>Dr Lance Ford, Zoom</i>	
			⚡ AI personas in community-engaged courses <i>Margaret Sass, Boise State University</i>	
			⚡ Connecting AI, Best Teaching Practices, and Instructional Design <i>Jen Elbek, University of Idaho</i>	
	BREAK		BREAK	
10:00am to 10:45am	AV and USB-C Technologies: Transforming Learning Spaces for Success <i>Joseph Frotton, Extron</i>		⚡ How to Be Efficient in Ten Minutes <i>Erik Talbert, Idaho State University</i>	
			⚡ Applied Acoustics: Conferencing Tech is Not a Computer Peripheral, It's a Room Peripheral <i>Jeremy Krug, Biamp</i>	
			⚡ What software do you ROCK??? <i>Dr Lance Ford, Zoom</i>	
	BREAK	BREAK	BREAK	
11:00am to 11:45am	Zoom Spaces AV from USB/HDMI to On-Net to Cloud - Making the Connection! <i>Dr. Lance Ford, Zoom</i>	Evidence Based Teaching with iClicker <i>Grace Tuttle, Macmillan Learning</i>	Setting Expectations with Your Integration Partner as an In-House Integrator in Higher Education <i>Jimmie Singleton, AVI-SPL, and Christopher Dechter, University of Wyoming</i>	
Noon - 1:00pm	<b>Lunch</b> Student Union Building Jordan Ballroom Sponsored by CDW			
1:00pm to 1:45pm	Making Friends with Facilities and Crushing Capital Projects <i>Mike Pedersen, Iowa State University; Josh Hamon, Stantec; Evan Danforth, Erika Krishnek, &amp; Lynn Solmon Boise State University</i>	Zoom in to Zoom Room Classrooms – A Case Study <i>Jim Wellings, Steve Campbell, Utah State University</i>	10 Step of -Ate: A Method for Madness <i>Kevin Lee, Pepperdine University</i>	
		BREAK	BREAK	
2:00pm to 2:45pm		Leveraging Data to Impact Classroom Issues Beyond Our Control -- Cass Hall, <i>University of Idaho</i>	Shining a Light on Classroom AV Usage <i>Kiana Felker, Pepperdine University</i>	
3:00pm - 4:30pm	Exhibitor Showcase in Jordan Ballroom			
4:30pm- 6:00pm	Boise State Campus Tour			
6:00pm - 7:30pm	<b>Dinner</b> Student Union Building Jordan Ballroom Sponsored by Planar			

## Thursday Conference Schedule

ROOM:	Bishop Barnwell	Farnsworth	Bergquist	
8:00am - 9:00am	Breakfast Student Union Building Jordan Ballroom			Meet the Sponsors of NW/MET in the Exhibitor Area
9:00am to 9:45am	Using AI Tools for Student Research <i>Bethany Schultz and Christa Sandidge, Northwest Nazarene University</i>	Maximizing Hybrid Learning: Does having more cameras matter? <i>Jordan Scales and Don Duterte, Crestron</i>	⚡How many cameras do you need? Dr Lance Ford, <b>Zoom</b>	
			⚡Auracast, Access and Accessibility Dan Case, <b>Carroll College</b>	
			⚡The UDL 3.0 Game Show Jo Ann Arinder, <b>University of Oregon</b>	
	BREAK	BREAK	BREAK	
10:00am to 10:45am	The Value of ATHEN: Access Technology Higher Education Network <i>Natalie Davison, Boise State University</i>	Mastering USB-C and USB <i>Donald Trinh and Jason Parson, Atlona (repeat)</i>	An Ed Tech Tragedy or Blessing in Disguise? <i>Frank Alaimo and Andy Borts, University of Nevada Las Vegas</i>	
	BREAK		BREAK	
11:00am to 11:45am	Designing for the Human Factors of AV <i>Mike Pedersen, Iowa State University</i>		Bringing Classroom Potential to Life Through Technology and Pedagogy <i>Frank Rosa, Talem3</i>	
Noon - 1:00pm	Lunch Student Union Building Jordan Ballroom Sponsored by Panopto			
1:00pm to 1:45pm	Transitioning Phone Services to the Cloud <i>Peter Jurhs, Boise State University; Patrick Carlton, CompuNet</i>	Expanding Physical Therapy Education in Idaho with the Help of Technology <i>Erik Talbert and Dr. Deanna Dye, Idaho State University</i>	Interactive AV Solutions for Modern Learning: A SMART Approach <i>Melissa Jenkins, SMART Technologies</i>	
1:45pm - 4:30pm	Exhibitor Showcase in Jordan Ballroom			
	BREAK			
5:30pm - 6:00pm	Group Photo on the Blue Turf			
6:00pm - 9:30pm	Dinner and Closing Party Double R Ranch Room Stueckle Sky Center Keynote Speaker and Auction to spend MET Money Sponsored by Biamp			



## Friday Conference Schedule

8:00am - 9:00am	<b>Breakfast</b> Student Union Building Jordan Ballroom
8:30am to 9:30am	NW/MET Annual Business Meeting / Closing Remarks - All are welcome!
10:00am to 11:00am	Boise State Stein Luminary Tour
11:30am to 12:30pm	Boise State Esport Arena
12:30pm	Bus load up to ISU
1:00pm to 1:30pm	<b>Lunch</b> Idaho State University - Meridian
1:30pm to 2:30pm	ISU Meridian - Anatomy Lab Tour
2:30pm	Bus load up back to BSU
<i>See you next year in Salt Lake City!</i>	

## 2026 NW/MET Conference in Salt Lake City

We are excited to announce that the 2026 NW/MET Conference location and host. Join us March 9th to the 13th in Salt Lake City at the University of Utah in Salt Lake City, Utah!

Salt Lake City offers a central location with easy access for attendees, along with a vibrant tech scene and a growing reputation as a hub for innovation. The city's combination of modern amenities and scenic natural beauty provides a welcoming atmosphere for professionals to engage, collaborate, and recharge. The University of Utah, with its cutting-edge research facilities and robust educational programs, is a natural fit for a conference focused on the future of educational technology. The university's commitment to innovation in teaching and learning aligns perfectly with the conference's goals of sharing best practices, emerging trends, and the latest tools in the field.



## Conference Session Map

The conference sessions take place in the Bishop Barnwell Room, Farnsworth Room, and the Bergquist Room. The Jordan Ballroom is the location for the Exhibitor Showcase, the Wednesday night dinner, and breakfasts and lunches during the conference.

### 2<sup>nd</sup> Floor of the BSU Student Union Building

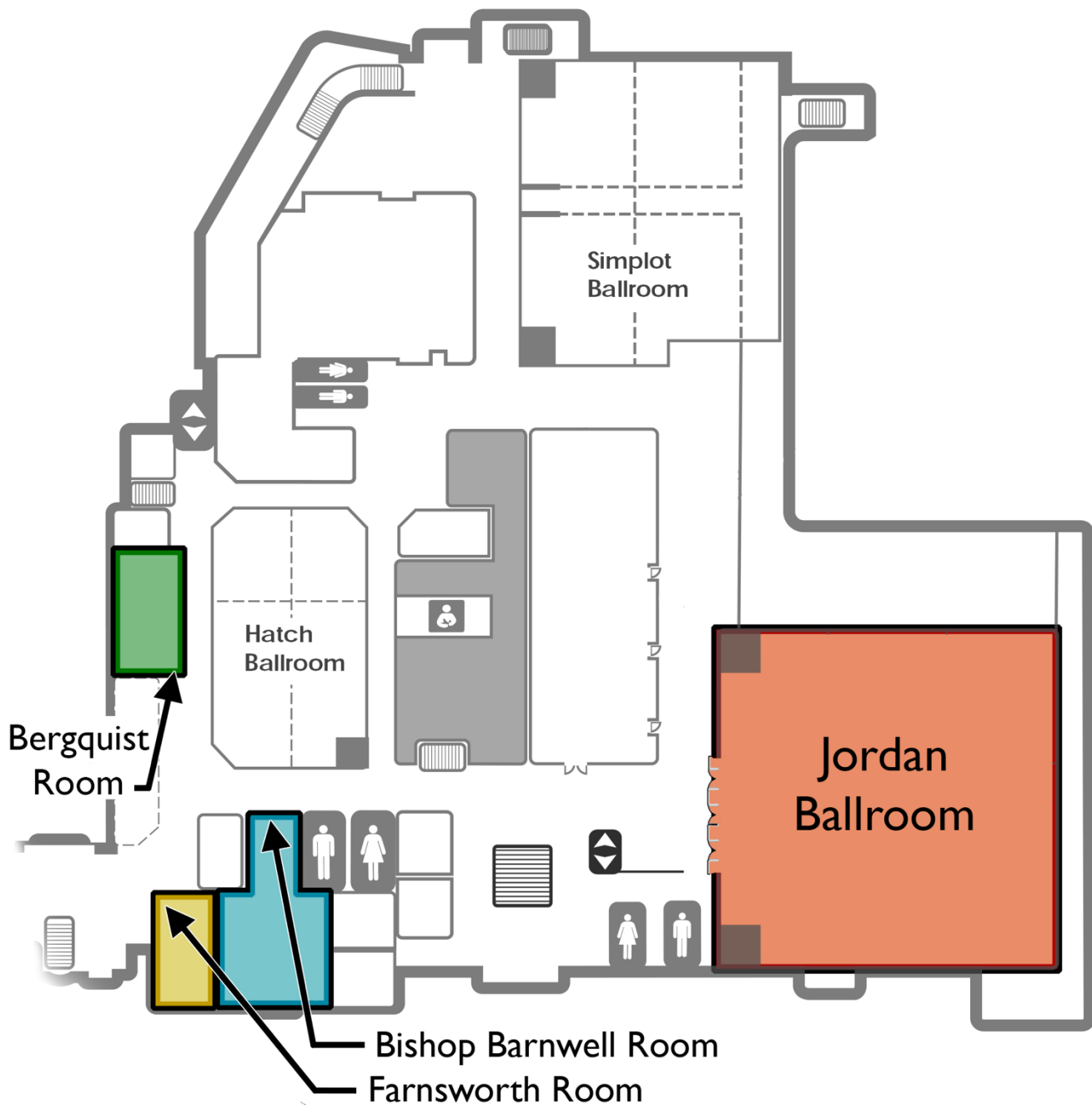



## Conference Sessions

Conference sessions are listed by day and room location.  
For the full schedule, see pages 9 and 10.

### WEDNESDAY

*Bishop Barnwell Room*

#### **Be Heard and Sound Better - How to Setup Audio DSP Like an Audio Engineer**

*Jeremy Krug -- Biamp Systems*

**9:00am to 9:45am**

We have incredibly powerful tools in our technological toolbox today that can work wonders to improve audio clarity, intelligibility, and overall sound quality. But if your background is more on the IT, Video, Facilities, or other technologies, knowing just how to turn the dials to get the best sound may be a bit foreign. Let a veteran recording studio engineer, teacher, and author explain a handful of tools and concepts that will help you get the most out of your sound system.

#### **AV and USB-C Technologies: Transforming Learning Spaces for Success**

*Joseph Frotton -- Extron*

**10:00am to 10:45am**

In today's dynamic educational landscape, harnessing the power of USB in audiovisual systems is essential for creating immersive and engaging learning environments. Like all technology, Universal Serial Bus - USB has evolved over time. USB-C now offers a much wider set of functionality including data, video, audio, and power delivery, becoming a standard component of many AV systems. With increased bandwidth, a smaller connector format, and support from major device manufacturers, USB-C is primed to be the leading interface for laptops and Unified Communications. This session delves into the fundamentals of USB for professional audiovisual systems, including USB microphones and cameras. Explore strategies for leveraging these technologies to create flexible learning spaces that foster interactive and hybrid learning methods. Discover the importance of selecting the right cables and the role of power wattage for ensuring successful integration of USB-C devices. Dive into approaches for switching and distributing video, audio, and USB data, facilitating content delivery. Learn considerations for implementing future-ready systems that can adapt to evolving requirements.

#### **Zoom Spaces AV from USB/HDMI to On-Net to Cloud - Making the Connection!**

*Dr. Lance Ford -- Zoom*

**11:00am to 11:45am**

Zoom Spaces AV moves beyond traditional USB and HDMI connections as AV sources. In 2024, The Zoom Spaces Development team has made a series of announcements that have elevated the AV experience to a whole new level! Supporting NDI and Dante inbound as well as outbound allows for flexible deployment options that can dramatically expand a collaboration experience. Zoom Spaces ProAV can provide a control interface allowing you to route sources between a variety of spaces leveraging a slew of resources that are not physically connected to a third-party AV infrastructure engine. Zoom Spaces latest expansion includes an opportunity to dynamically connect additional Zoom Spaces Touch Devices to increase or compliment the number of cameras, displays and annotation surfaces, providing the ability to create robust ad-hoc AV collaboration experiences without the need of any of physical connections by leveraging the cloud as an AV engine. In this session, we want to share with you some of our roadmap and reasoning behind it, as well as gather your feedback on what Zoom is working on in 2025.



## **Making Friends with Facilities and Crushing Capital Projects**

*Mike Pedersen -- Iowa State University*

*1:00pm to 2:45pm*

*Josh Hamon -- Stantec*

*Evan Danforth, Erika Krishnek & Lynn Solmon -- Boise State University*

Whether cookie cutter or cutting edge, collaborating is essential to delivering supportable, enterprise level AV systems. Learn from BSU AV, BSU Capital Projects and others about their past and current relationship. How they get and keep a seat at the table of every campus project. This session aims to provide some tips and tricks on how to make friends with your facilities team and start the process toward more successful capital project implementations. Filled with real-world examples of failure and success, this practical session provides insights to improve trust and communication and ultimately lead to more successful projects.

### *Farnsworth Room*

## **Mastering USB-C and USB**

*Donald Trinh & Jason Parson -- Atlona*

*9:00am to 10:45am*

Qualifies for Avixa credit!

Are you ready to elevate your AV expertise? A comprehensive overview of USB(-C) technology, best practices and common mistakes in AV environments, and troubleshooting tools and techniques to streamline your setup, led by AV legend Donald Trinh. Gain essential insights into USB and USB-C technology for effective AV environments!

*\*\*Same session offered Thursday @ 10:00am\*\**

## **Evidence Based Teaching with iClicker**

*Grace M. Tuttle -- Macmillan Learning*

*11:00am to 11:45am*

This quasi-quantitative study explored the effects of iClicker in University Foundation 100 classes at Boise State University. This research evaluates data of 7,812 between Spring 2017 to Fall 2019 between Clicker group and non-clicker group. The main conclusion of this study is that polling is a statistically significant predictor of higher final course grades.

## **Zoom in to Zoom Room Classrooms – a case study**

*Jim Wellings & Steve Campbell -- Utah State University*

*1:00pm to 1:45pm*

Description: Utah State University maintains a large distance learning network connecting more than 30 locations and 200 classrooms across the state, until recently using Cisco teleconferencing hardware to deliver more than 60 programs and 600 courses. USU adopted Zoom in 2020, adding support to more than 160 main campus classrooms that were not already Cisco connected. Since 2022, we have worked to upgrade our existing Cisco spaces to Zoom Rooms, with our developers using Zoom's API to automatically create and configure Zoom meetings for courses and make them available in our Canvas LMS. Zoom Rooms presented an opportunity for us to manage, control, and improve our Zoom experience. Two years into our upgrade project, more than 260 Zoom Room licenses have been deployed statewide. We will share insights, experiences, hard lessons, and successes from our Zoom Room transition and system upgrades.

## Leveraging Data to Impact Classroom Issues Beyond Our Control

*Cass Hall -- University of Idaho*

**2:00pm to 2:45pm**

It takes a village to solve the many inherent problems with classroom scheduling and usage: faculty placed in locations that don't have the right technology to meet their needs, faculty insisting on a room near their office, too many courses being taught during the same time slot, no backup locations for classes to be moved in case of outages/flooding, lack of flexible learning spaces - the list goes on and on. After years of tolerating the issues we couldn't control though they were deeply impacting our classroom technology support team, we found a way to tackle the problem by inviting the village to a data party. Join me to learn about the data utilized and the workarounds and compromises that solved the problems.

*Bergquist Room*

---

### Lightning Rounds

**9:00am to 9:45**

#### ⚡ AI and Physical Spaces - Stop writing notes and start engaging

*Dr. Lance Ford -- Zoom*

Using Zoom Rooms to become ingestion points for Zoom AI Companion as well as other lecture capture tools that enhance, streamline and safeguard all the content created in class.

#### ⚡ AI Personas in Community-Engaged Courses

*Margaret Sass -- Boise State University*

This lightning talk will discuss an innovative method of leveraging AI-driven personas to enhance students' understanding of diverse stakeholder perspectives, facilitating better communication and collaboration with community members. Attendees will gain insights into how this method can be applied within their own courses to create interactive learning environments that support meaningful, impactful partnerships.

#### ⚡ Connecting AI, Best Teaching Practices, and Instructional Design: An AI-Pedagogy Support Model

*Jendra (Jen) Elbek -- University of Idaho*

Faculty in higher education have expressed concern over two prominent challenges: limited time to improve teaching practices, and concerns about students misusing AI. This presentation introduces a new model that illustrates the complementary relationship between AI use, best teaching practices, and instructional design support. Applying the concepts represented by this model can potentially help to reduce faculty workload, foster authentic student engagement, alleviate some of the apprehension of AI use, and lessen academic dishonesty.

### Lightning Rounds

**10:00am to 10:4am**

#### ⚡ How to Be Efficient in Ten Minutes

*Erik Talbert -- Idaho State University*

The truth is, you cannot "become" efficient, nor can you learn how in ten minutes. But you can and should always be working at it. I've spent most of my career in higher ed support, and teaching roles, and have learned that working efficiently is a massively useful skill. I will share some general efficiency tips, and offer examples from my work in AV and IT.

## ⚡ **Applied Acoustics: Conferencing Tech is Not a Computer Peripheral, It's a Room Peripheral**

**Jeremy Krug -- Biamp Systems**

Is it certified for Teams? Or Zoom? Or THX? None of that really matters if you don't match your AV conferencing technology to the physical room where it will be used. Here are a few quick tips that can save you money, save you time, and help you find success with AV systems.

## ⚡ **What software do you ROCK???**

**Dr. Lance Ford -- Zoom**

How third-party software integrations create a cohesive AV experience for your end users - Event Management System? Learning Management Systems? Digital Signage Software? ZOOM ROOMS are the GLUE!!!!

## **Setting Expectations with Your Integration Partner as an In-House Integrator in Higher Education**

**Jimmie Singleton -- AVI-SPL**

**11:00am to 11:45am**

**Christopher Dechter -- University of Wyoming**

Already have an in-house integration team or looking to move toward in-house integration at your institution? When should you engage a commercial integration partner and how do you set proper expectations to ensure that you are still involved as a stakeholder? Join this session with the team from AVI-SPL and the in-house AV team from the University of Wyoming to learn how they truly work together as partners on projects and set proper expectations with each other throughout the process. This session will dive into how to manage a joint project and overcome issues that arise throughout the process, ensuring that the institution is getting exactly what they need to serve their students, and that the integration partner is setup for continued success and work with the institution.

## **10 Step of -Ate: A Method for Madness**

**Kevin Lee -- Pepperdine University**

**1:00pm to 1:45pm**

With a handful of skilled technicians supporting hundreds of classrooms for thousands of faculty; how can an audiovisual technologies team keep track of chronic issue resolutions among the sea of noise and madness? At Pepperdine University, a simple, transparent, and memorable system is used to monitor overarching problems while not losing focus of day-to-day support. Join us for a discussion of how this is done and share your madness with us.

## **Shining a Light on Classroom AV Usage**

**Kiana Felker -- Pepperdine University**

**2:00pm to 2:45pm**

As an audiovisual support team, we assist with the integration of new classroom technology and provide maintenance and support when issues arise. There's a gap of visibility when it comes to how the rooms are used. We can collect anecdotes from specific faculty members but being able to illuminate the way in which classroom AV systems are interacted can help us design more effective classrooms. Join us for a conversation about how Pepperdine's AV Technologies team set up such an environment and what new insights can be collected.



**THURSDAY***Bishop Barnwell Room***Using AI Tools for Student Research*****Bethany Schultz & Christa Sandidge -- Northwest Nazarene University******9:00am to 9:45am***

This session will explore the evolving role of AI in student research, focusing on ethical considerations and practical applications across various stages of the research process. Participants will gain insights into how researchers are using AI, learn ethical guidelines for its use, and tools for refining topics, analyzing data, and enhancing their research workflow.

**The Value of ATHEN: Access Technology Higher Education Network*****Natalie Davison -- Boise State University******10:00am to 10:45am***

Ed Tech Specialists are often consulted regarding how to build accessible courses and remediate the accessibility of course materials. ATHEN is a professional organization that brings together diverse professionals to spread information and consult about Access Technology best practices and innovations. Join this session to learn how ATHEN can support your work facilitating accessibility in courses!

**Designing for the Human Factors of AV*****Mike Pedersen -- Iowa State University******11:00am to 11:45am***

Description: In this class we will do a crash course in a narrow segment of human factors - looking at the sensory and cognitive capabilities and limitations of humans and some corresponding best practices for design. We'll study the human information processing model to learn how humans receive and interpret their world. Then we'll look at the seven stages of action and consider the gulfs of evaluation and execution. Finally, we'll get practical and look at system design methods that can be utilized to help people overcome the two gulfs including concepts such as affordances, conceptual models, making things visible, giving feedback, and mapping.

**Transitioning Phone Services to the Cloud*****Peter Jurhs -- Boise State University******1:00pm to 1:45pm******Patrick Carlton -- CompuNet***

Boise State University is modernizing its phone system by moving to the cloud for phone services. The University selected Zoom Phone as its platform. The presentation will walk through the key decision points to consider, and lessons learned. By attending, hopefully, it will allow you to avoid some of the pitfalls in the migration process.

*Farnsworth Room***Maximizing Hybrid Learning: Does having more cameras matter?*****Jordan Scales & Don Duterte -- Crestron******9:00am to 9:45am***

Remote learning has become an integral part of education, especially in today's environment. However, ensuring equity for remote participants in lecture hall settings has historically been a challenge. Traditional methods often left remote students feeling disconnected from the in-person experience, leading to decreased engagement and participation. In this presentation, we will explore the evolution of remote learning in lecture halls, identify past challenges, and highlight new technologies and tools that foster inclusivity for both students and faculty. Get a better understanding of how to use 2 or more cameras in Remote Learning environments, discuss different methods camera positioning and whether using more than one camera can provide a more engaging experience, and get ideas about how different viewing experiences will impact your hybrid room designs.

## Mastering USB-C and USB

**Donald Trinh & Jason Parson -- Atlona**

**10:00am to 11:45am**

**\*\*Same session offered Wednesday @ 9am – Farnsworth Room\*\***

## Expanding Physical Therapy Education in Idaho with the Help of Technology

**Dr. Deanna Dye & Erik Talbert -- Idaho State University**

**1:00pm to 1:45pm**

In 2018, Idaho State University began offering its long-established DPT program from its main campus in Pocatello, ID to a second cohort at its health science campus in Meridian, ID. But it was not simply broadcasting existing content so remote students could follow along. ISU's physical therapy program has students and faculty on both sites, and the cohorts progress together largely through synchronous classroom videoconferencing. This session will detail the process, challenges, and triumphs with two people who have been part of it from the beginning--the faculty member and department director who helped lead the effort, and the AV/IT staff person who was hired specifically to support it.

*Bergquist Room*

## Lightning Rounds

**9:00am to 9:45am**

### ⚡ How many cameras do you need?

**Dr. Lance Ford -- Zoom**

Versatility of Zoom Room to add cameras and AV resources over the cloud - 4 Cameras (physical bus or NDI (with control) + 3 cameras (on ZR in companion mode)

### ⚡ Auracast, Access and Accessibility

**Dan Case -- Carroll College**

Will the new Bluetooth standard of Broadcast Audio be a big thing on college campuses or is it just hype? Find out more about this new standard and its potential uses not just in the classroom and for accessibility, but all over campus.

### ⚡ The UDL 3.0 Game Show

**Jo Ann Arinder -- University of Oregon**

This quick gamified session will cover the basic changes and what they really mean to us. Discover the UDL updates present in the new 3.0 guidelines. A short introduction explaining the motivation for the updates and the history of the UDL guidelines will be provided. Then the main changes will be highlighted.

## An Ed Tech Tragedy or Blessing in Disguise?

**Frank Alaimo & Andy Borts -- University of Nevada Las Vegas**

**10:00am to 10:45am**

We will take a dive into the required needs for classroom refresh / new initiative support in the wake of the C-19 aftermath. Universities had to leverage new technology for faculty and students but has this trend continued or cooled? Leadership was looking to equip your campuses with technologies that enable more efficient and effective teaching at the time of need but has that need remained or has the technology refresh cycle been forgotten again? Investments in ed-tech were needed not only during the pandemic but also beyond it. How is your university leadership supporting your team's endeavor in the on-going support model?

## Bringing Classroom Potential to Life Through Technology and Pedagogy

**Frank Rosa -- Talem3 Business Solutions**

**11:00am to 11:45am**

Unlock the full potential of classroom technology and assets by joining our session on empowering faculty with effective use of classroom audio-visual tools and assets. We'll explore the pedagogical value of classroom technologies and versatile learning spaces, focusing on strategies that enhance student engagement and learning outcomes. This session will provide a practical solution to three key business challenges: enhancing faculty training on the pedagogical value of classroom assets, establishing an effective channel for faculty feedback on learning spaces, and enabling virtual room visits for upgrade design and planning.

## Interactive AV Solutions for Modern Learning: A SMART Approach

**Melissa Jenkins -- SMART Technologies**

**1:00pm to 1:45pm**

Discover how SMART Technologies' interactive AV solutions are transforming modern learning environments. This session will showcase innovative tools and strategies that enhance student engagement, streamline collaboration, and support both in-person and hybrid classrooms. Learn how these cutting-edge solutions bridge AV and IT to create dynamic, adaptable spaces that prepare students for future success.

*Thank you to all the presenters!*

## Keynote Speaker – Max Davis-Johnson

**Thursday Night Dinner**

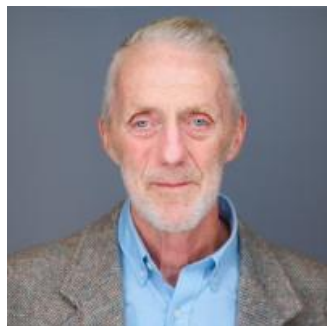

Max Davis-Johnson is a highly experienced Chief Information Officer (CIO) and technology leader with a distinguished career spanning multiple universities and industries. He currently serves as the CIO and Associate Vice President at Boise State University, where he leads the Office of Information Technology. His work focuses on enhancing instructional, research, and administrative technologies, with notable achievements in areas like cloud migration, high-performance computing, instructional technologies and cybersecurity.

Max's previous roles include Interim CIO and Deputy University Technology Officer at Arizona State University, and Director of Administrative Computing at Northern Arizona University. Across his career, he has successfully led major system implementations, including Oracle PeopleSoft projects, data warehouses, and other enterprise applications. He is known for his transformational leadership, strategic planning, and dedication to customer-centric service delivery. Max has also presented extensively at conferences and events, contributing thought leadership in areas like IT governance, research computing, and enterprise technology implementation.

In addition to his professional achievements, Max has been actively involved in civic and professional organizations, such as the Idaho Governor's Cybersecurity Taskforce and the Idaho Regional Optical Network Board of Directors. He also co-founded Hackfort which is an integral part of the annual Boise Treefort festival.



## Boise State - Educational Technology Programs

Boise State University's Educational Technology Programs offer innovative, fully online graduate degrees and certificates designed for educators, instructional designers, and professionals seeking to enhance their expertise in technology integration, online teaching, and instructional design. With flexible, asynchronous courses, these programs cater to working professionals worldwide, providing hands-on experiences in designing online courses, developing instructional media, and leveraging digital tools for education. Students can pursue a Master of Educational Technology (M.E.T.), an Educational Specialist (Ed.S.), a Doctor of Education (Ed.D.) in Educational Technology, or specialized graduate certificates in areas like online teaching, technology integration, accessible course design, and artificial intelligence. Led by expert faculty, these research-driven programs emphasize cutting-edge instructional practices and the latest advancements in educational technology. Whether you're looking to advance your career, lead in instructional design, or innovate in online learning, Boise State's EDTECH programs provide the skills and knowledge to excel in the evolving digital education landscape.



For additional Information:

Patrick Lowenthal  
patricklowenthal@boisestate.edu  
Educational Leadership, Research, and Technology

## AV Superfriends



The AV SuperFriends are a group of Audio & Video, Higher Education Technology and eLearning nerds, sharing their successes and failures related to the intersection of AV and pedagogy. Come with us as we explore AVoIP, Classroom, Broadcast, and Collaboration Technology!

Christopher Dechter  
*University of Wyoming*  
Jamie Rinehart  
*University of Missouri - Kansas City*  
Marc Cholewczynski  
*Oregon State University*  
Larry Darling  
*University of North Carolina - Greensboro*  
Justin Rexing  
*Western Kentucky University*

Visit the AV SuperFriends at

**avsuperfriends.com**

YouTube - youtube.com/@avsuperfriends

X - @AVSuperFriends

LinkedIn - linkedin.com/company/avsuperfriends

Email - mailbag@avsuperfriends.com

At NW/MET Conference 2025, the AV Superfriends will host the recording of their podcast. Look for them in the Jordan Ballroom during breakfast and lunch sessions.

## Exhibitor Map – Jordan Ballroom

The exhibitor showcase will be buzzing with excitement on Wednesday and Thursday—don't miss your chance to connect with the brilliant sponsors who make this conference possible! Stop by, say hello, gather your MET Money, and discover all the innovative products and services they're showcasing. It's the perfect opportunity to network, learn, and maybe even score some cool swag!

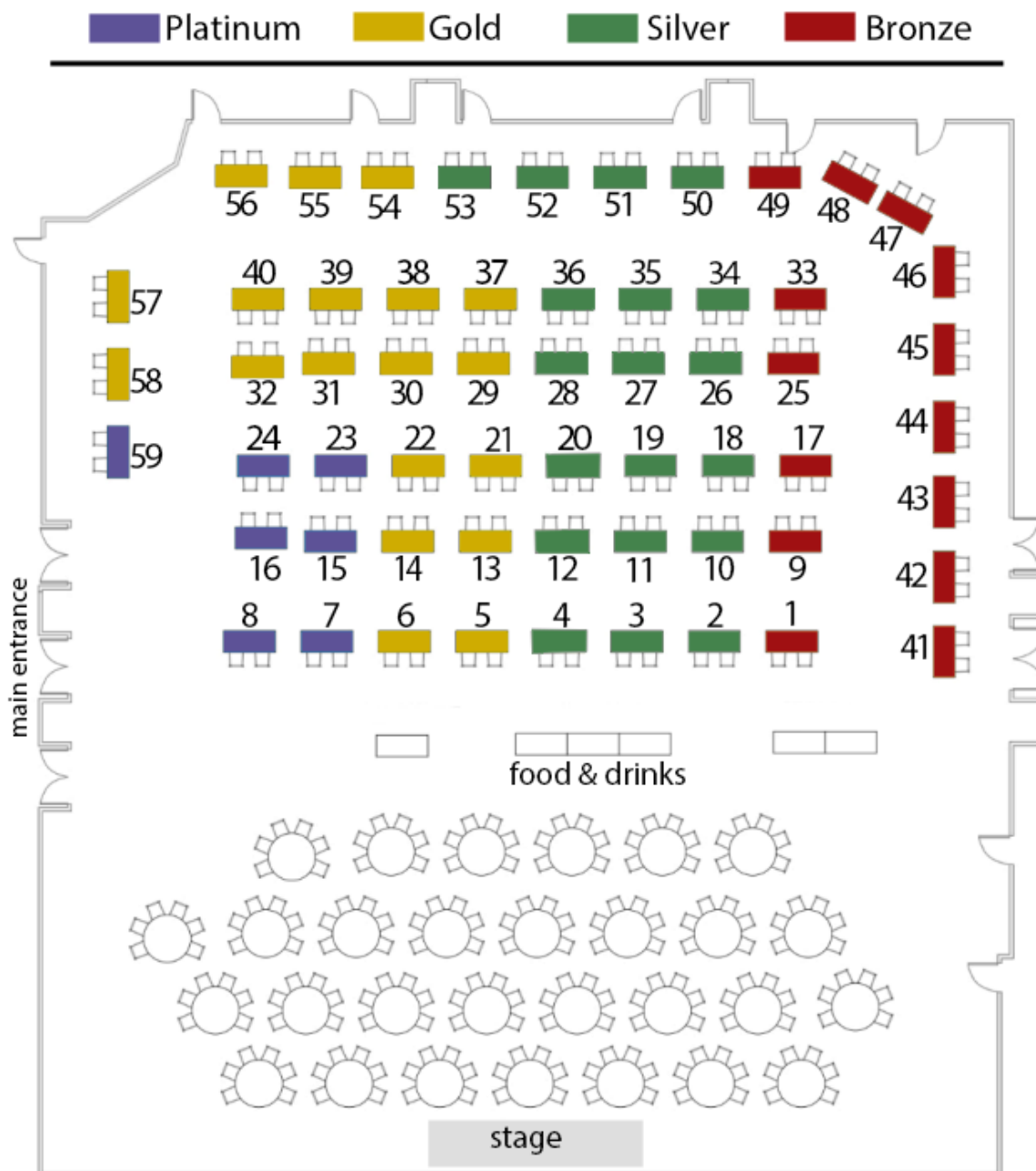

## Sponsor List with Table Number:

Table	Exhibitor & Sponsor
1	B&H B2B
2	Gan Systems Inc.
3	HETMA
4	Draper
5	WolfVision
6	Daktronics
7	CDW
8	Biamp
9	Macmillan Learning
10	INOGENI
11	YuJa
12	Intelligent Video Solutions
13	Atlona
14	Catchbox
15	Panopto
16	CCS Presentation Systems
17	Bose Professional
18	Legrand
19	Appspace
20	Peerless AV & Sony
21	CompuNet, Inc.
22	Bluum
23	AVI Systems, Inc. & Newline Interactive
24	Planar
25	QSC/QSYS
26	Neat
27	Sennheiser
28	Williams AV
29	Liberty AV Solutions & Muckle Sales

Table	Exhibitor & Sponsor
30	AVI-SPL
31	Epson America Inc.
32	LG Electronics
33	TEKVOX Drop-In AV
34	Visix
35	LightWerks
36	Audio-Technica
37	Alfatron
38	Panasonic
39	SMART Technologies
40	Symetrix
41	Brownestone
42	
43	TWT Audio
44	ELMO USA Corp
45	HP POLY
46	Kramer AV
47	Computer Comforts
48	Avocor
49	Diversified
50	Dante
50	Lumens Integration Inc.
51	OETC
52	Clear Touch
53	Vivi
54	Talem3
55	Extron
56	Zoom Communications, Inc & Jabra
57	Spectrum Industries, Inc.
58	JAR Systems
59	Crestron



## Our Exhibitors & Sponsors

The 2025 NW/MET Conference could not be possible without the support of our sponsors. You will meet our sponsors on the exhibition floor. Please consider visiting their website for more information about their products and services.

*Thank you!*  
TO OUR SPONSORS

### PLATINUM Sponsors



**biamp.**



**newline**



GOLD Sponsors



## SILVER Sponsors

 APPSPACE

 audio-technica

 ClearTouch

 Dante®

 DRAPER®  
FOCUSED ON INNOVATIVE SOLUTIONS

 epiphan video

**HETMA**  
HIGHER EDUCATION TECHNOLOGY MANAGERS ALLIANCE

**INOGENI**

  
INTELLIGENT  
VIDEO SOLUTIONS

 legrand® | AV

 LIGHTWERKS  
COMMUNICATION PERFECTED

**Lumens®**

**neat.**

 OETC

**peerless-AV®**

 SENNHEISER

**SONY**

 visix®

 vivi

**WILLIAMS AV**

 YuJa

## BRONZE Sponsors

avocor

**B&H**  
PHOTO • VIDEO • AUDIO

**BOSE**

 Brownstone  
— ONLY SOFTWARE IS BETTER —

 CCI

PROFESSIONAL

 Diversified.

**ELMO**

 poly

 kramer

 macmillan  
learning

 Q-SYS®

**TEKVOX**  
Drop-in AV®

 TWT  
AUDIO  
— A Division of Sonosound Technology® —



*Imagine the  
Possibilities,  
Achieve the  
Extraordinary!*

**NC STATE UNIVERSITY**

October 14-17, 2025 | Raleigh, NC

**etc**

EDUCATIONAL TECHNOLOGY COLLABORATIVE

**2025 ANNUAL  
CONFERENCE**

Submit your topic  
proposal for the ETC 2025  
Annual Conference!  
Submissions due **May 1st.**



Conference website QR

October 16 & 17  
Lane Community College  
Eugene, Oregon

**NWeLearn 2025**

[nwelearn.org/conference](https://nwelearn.org/conference)



